

Straight swivel joints male-female threads

slow

Suitable: For slow rotary movements, e.g. to avoid the twisting of hoses.

Materials: Body: Brass nickel-plated, seal: NBR

Temperature range: -20°C to max. +80°C

Operating pressure: -0.99 to 15 bar

Media: Oiled compressed air

Type	Thread male	Thread female
DREH 18 MSV	G 1/8"	G 1/8"
DREH 14 MSV	G 1/4"	G 1/4"
DREH 38 MSV	G 3/8"	G 3/8"



Angle and T-swivel joints are found on page 53.

Outstanding value!



360° rotatable

Quick swivel joints

up to 1500 rpm

Suitable: As a rotating compressed air supply in mechanical engineering

Materials: Body: Brass nickel-plated, pivot pins: Zinc-plated steel, ball bearing: Steel, seal: NBR

Temperature range: 0°C to max. +60°C

Operating pressure: -0.95 to 10 bar

Media: Compressed air, neutral gases

Type	Thread male	Thread female	U _{Max} *
GFS 18	G 1/8"	G 1/8"	1500
GFS 14	G 1/4"	G 1/4"	1200
GFS 38	G 3/8"	G 3/8"	1000
GFS 12	G 1/2"	G 1/2"	1000

* depends on operating time



360° rotatable
up to 1.500 U/min

Rotary distributors rotatable 4-way

up to 300 rpm

Suitable: As a rotating compressed air supply in mechanical engineering

Materials: Body: Aluminium anodised, pivot pins: Stainless steel, ball bearing: Steel, seal: NBR

Temperature range: 0°C to max. +80°C

Operating pressure: -0.95 to 10 bar

Media: Oiled compressed air

Type	G 1	G 2	SW
GF 14 A	G 1/4"	4 x G 1/4"	17
GF 38 A	G 3/8"	4 x G 3/8"	19



360° rotatable
up to 300 U/min

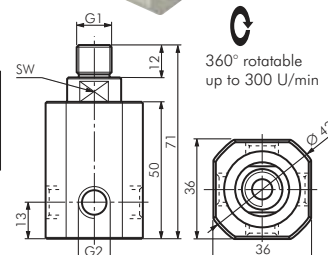

Swivel joints with male and female threads

for tools

Suitable: For reduced rotary movements, e.g. connection to compressed air tools, especially for suspended compressed air tools.

Materials: Brass nickel-plated/plastic

Temperature range: 0°C to max. +60°C

Operating pressure: 0 - 15 bar

Media: Compressed air

Type	Thread female	Thread male	Version
Precision version			360° rotatable
DREHGELENK 14	R 1/4" (conic)	R 1/4"	3-way
DREHGELENK 38	R 3/8" (conic)	R 3/8"	2-way
DREHGELENK 12	R 1/2" (conic)	R 1/2"	2-way
Standard version			
DREHGELENK 14 B	Rp 1/4"	R 1/4"	2-way



360° rotatable

precision version

360° rotatable

360° rotatable

360° rotatable

standard version

360° rotatable

Swivel joints with male and female threads

for tools

Suitable: For slow rotary movements, e.g. to avoid the twisting of hoses

Materials: Steel nickel-plated

Temperature range: 0°C to max. +60°C

Operating pressure: 0 - 15 bar

Media: Compressed air

Type	Thread	Connection
DG 1414 IA	G 1/4" (FT)	R 1/4" (MT)
DG 3838 IA	G 3/8" (FT)	R 3/8" (MT)
DG 14 KSNW7*	G 1/4" (MT)	Plug NW 7.2

* 50° pivotable

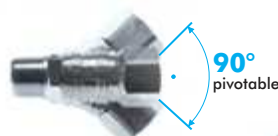

360° rotatable



360° rotatable



360° rotatable

All data are considered to be unbinding reference values. We accept no liability for data selection that is not confirmed in writing. Pressure data refer, if not otherwise indicated, to liquids of Group II at +20°C.