

## Tube elbows 90° design type 3S<sup>1)</sup>

## EN 10253 type A (DIN 2605)

Continued from  
previous page

Type AISI 316Ti <sup>INOX</sup>	Type AISI 321 <sup>INOX</sup>	Type AISI 316Ti <sup>INOX</sup>	Type AISI 321 <sup>INOX</sup>	Type P235GH-TC1 steel black	Connection D x S
Welded design		Seamless design			
W76,120GA6	W76,120GA4	W76,120A6	---	---	76.1 x 2.0
W76,126GA6	W76,126GA4	W76,126A6	W76,126A4	---	x 2.6
W76,129GA6	W76,129GA4	W76,129A6	W76,129A4	W76,129ST	x 2.9
W76,136GA6	W76,136GA4	W76,136A6	W76,136A4	W76,136ST	x 3.6
---	---	W76,140A6	W76,140A4	W76,140ST	x 4.0
---	---	W76,150A6	W76,150A4	W76,150ST	x 5.0
W88,920GA6	W88,920GA4	---	---	---	88.9 x 2.0
W88,923GA6	W88,923GA4	---	---	---	x 2.3
W88,926GA6	W88,926GA4	W88,926A6	W88,926A4	---	x 2.6
W88,929GA6	W88,929GA4	W88,929A6	W88,929A4	---	x 2.9
W88,932GA6	W88,932GA4	W88,932A6	W88,932A4	W88,932ST	x 3.2
W88,940GA6	W88,940GA4	W88,940A6	W88,940A4	W88,940ST	x 4.0
W101,630GA6	---	---	---	---	101.6 x 3.0
W10420GA6	W10420GA4	---	---	---	104.0 x 2.0
W10820GA6	W10820GA4	---	---	---	108.0 x 2.0
W10830GA6	W10830GA4	W10830A6	W10830A4	---	x 3.0
W114,320GA6	W114,320GA4	---	---	---	114.3 x 2.0
W114,326GA6	W114,326GA4	W114,326A6	W114,326A4	---	x 2.6
W114,330GA6	W114,330GA4	---	---	---	x 3.0
W114,336GA6	W114,336GA4	W114,336A6	W114,336A4	W114,336ST	x 3.6
W114,340GA6	W114,340GA4	---	---	W114,340ST	x 4.0
---	---	W114,345A6	W114,345A4	W114,345ST	x 4.5
W12920GA6	W12920GA4	---	---	---	129.0 x 2.0
W13330GA6	W13330GA4	---	---	---	133.0 x 3.0
---	---	W13340A6	W13340A4	W13340ST	x 4.0
W139,720GA6	W139,720GA4	---	---	---	139.7 x 2.0
W139,726GA6	W139,726GA4	---	---	---	x 2.6
W139,730GA6	W139,730GA4	---	---	---	x 3.0
W139,740GA6	W139,740GA4	W139,740A6	W139,740A4	W139,740ST	x 4.0
W15420GA6	W15420GA4	---	---	---	154.0 x 2.0
W15930GA6	W15930GA4	---	---	---	159.0 x 3.0
W168,320GA6	W168,320GA4	---	---	---	168.3 x 2.0
W168,326GA6	W168,326GA4	---	---	---	x 2.6
W168,330GA6	W168,330GA4	---	---	---	x 3.0
W168,340GA6	W168,340GA4	---	---	---	x 4.0
---	---	W168,345A6	W168,345A4	W168,345ST	x 4.5
W20420GA6	---	---	---	---	204.0 x 2.0
W219,120GA6	W219,120GA4	---	---	---	219.1 x 2.0
W219,126GA6	---	---	---	---	x 2.6
W219,130GA6	W219,130GA4	---	---	---	x 3.0
W25420GA6	W25420GA4	---	---	---	254.0 x 2.0
W27330GA6	W27330GA4	---	---	---	273.0 x 3.0
W323,930GA6	W323,930GA4	---	---	---	323.9 x 3.0
W355,630GA6	W355,630GA4	---	---	---	355.6 x 3.0
W406,430GA6	W406,430GA4	---	---	---	406.4 x 3.0

\* standard delivery program, <sup>1)</sup> design type 3S: R=1.5D<sub>N</sub>, design type 5S: R=2.5D<sub>N</sub> on request

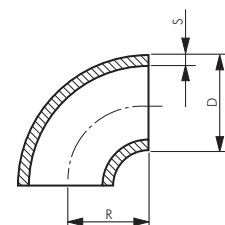

## Steel cable clamps

## similar to DIN 741

**Suitable:** Steel cable clamps are designed for the manufacture of removable cable-end connections.

Type zinc-plated steel	For cable Ø	G	H	W	Type AISI 316 <sup>INOX</sup>	For cable Ø	G	H	W
DSK 3	3	M 4	20	9	DSK 2 ES	2	M 3	17	7
DSK 5	5	M 5	24	11	DSK 3 ES	3	M 4	20	9
DSK 6	6.5	M 5	28	13	DSK 4 ES	4	M 4	22	10
DSK 8	8	M 6	34	16	DSK 5 ES	5	M 5	24	11
DSK 9	9.5	M 8	42	19	DSK 6 ES	6	M 5	28	13
DSK 11	11	M 8	44	20	DSK 8 ES	8	M 6	34	16
DSK 13	13	M 10	55	24	DSK 10 ES	10	M 8	42	20
DSK 14	14	M 10	57	25	DSK 13 ES	13	M 10	55	25
DSK 16	16	M 12	63	29	DSK 16 ES	16	M 12	63	30
DSK 19	19	M 12	75	32	DSK 19 ES	19	M 12	75	33
DSK 22	22	M 14	85	37	DSK 22 ES	22	M 14	85	38
DSK 26	26	M 14	95	41	DSK 24 ES	25	M 14	96	41
DSK 30	30	M 16	110	48					
DSK 34	34	M 16	120	52					
DSK 40	40	M 16	140	58					
DSK 45	45	M 18	165	65					
DSK 50	50	M 20	170	72					

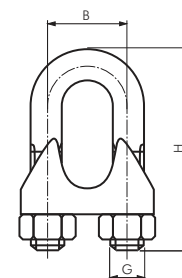

All data are considered to be unbinding reference values. We accept no liability for data selection that is not confirmed in writing. Pressure data refer, if not otherwise indicated, to liquids of Group II at +20°C.