

Welding flared disks DIN 2642 for loose flanges

PN 10

Type	DN	D	A	S
AISI 316Ti				
VB 10-2 ES	10	17.2	40	2.0
VB 15-2 ES	15	21.3	45	2.0
VB 20-2 ES	20	26.9	58	2.0
VB 20-2,5 ES	20	26.9	58	2.5
VB 25-2 ES	25	33.7	68	2.0
VB 25-2,5 ES	25	33.7	68	2.5
VB 25-3 ES	25	33.7	68	3.0
VB 32-2 ES	32	42.4	78	2.0
VB 32-2,5 ES	32	42.4	78	2.5
VB 32-3 ES	32	42.4	78	3.0
VB 40-2 ES	40	48.3	88	2.0
VB 40-2,5 ES	40	48.3	88	2.5
VB 40-3 ES	40	48.3	88	3.0
VB 50-2 ES	50	60.3	102	2.0
VB 50-2,5 ES	50	60.3	102	2.5
VB 50-3 ES	50	60.3	102	3.0
VB 65-2 ES	65	76.1	122	2.0
VB 65-2,5 ES	65	76.1	122	2.5
VB 65-3 ES	65	76.1	122	3.0
VB 65-4 ES	65	76.1	122	4.0
VB 80-2 ES	80	88.9	138	2.0
VB 80-2,5 ES	80	88.9	138	2.5
VB 80-3 ES	80	88.9	138	3.0
VB 80-4 ES	80	88.9	138	4.0
VB 100-2 ES	100	114.3	158	2.0
VB 100-2,5 ES	100	114.3	158	2.5
VB 100-3 ES	100	114.3	158	3.0
VB 125-2 ES	125	139.7	188	2.0
VB 125-2,5 ES	125	139.7	188	2.5
VB 125-3 ES	125	139.7	188	3.0
VB 150-2 ES	150	168.3	212	2.0
VB 150-2,5 ES	150	168.3	212	2.5
VB 150-3 ES	150	168.3	212	3.0
VB 200-2 ES	200	219.1	268	2.0
VB 200-2,5 ES	200	219.1	268	2.5
VB 200-3 ES	200	219.1	268	3.0
VB 200-3,5 ES	200	219.1	268	3.5
VB 200-4 ES	200	219.1	268	4.0
VB 250-3 ES	250	273.0	320	3.0
VB 250-4 ES	250	273.0	320	4.0
VB 300-3 ES	300	323.9	370	3.0
VB 300-4 ES	300	323.9	370	4.0
VB 350-3 ES	350	355.6	430	3.0
VB 350-4 ES	350	355.6	430	4.0
VB 400-3 ES	400	406.4	482	3.0
VB 400-4 ES	400	406.4	482	4.0
VB 500-3 ES	500	508.0	585	3.0
VB 500-4 ES	500	508.0	585	4.0

Type steel	DN	D	A	S
ST 35.8				
VB 15-2 ST	15	21.3	45	2.0
VB 20-2,3 ST	20	26.9	58	2.3
VB 25-2,6 ST	25	33.7	68	2.6
VB 32-2,6 ST	32	42.4	78	2.6
VB 40-2,6 ST	40	48.3	88	2.6
VB 50-2,9 ST	50	60.3	102	2.9
VB 65-2,9 ST	65	76.1	122	2.9
VB 80-3,2 ST	80	88.9	138	3.2
VB 100-3,6 ST	100	114.3	158	3.6
VB 125-4 ST	125	139.7	188	4.0
VB 150-4,5 ST	150	168.3	212	4.5
VB 200-6,3 ST	200	219.1	268	6.3
VB 250-6,3 ST	250	273.0	320	6.3
VB 300-7,1 ST	300	323.9	370	7.1

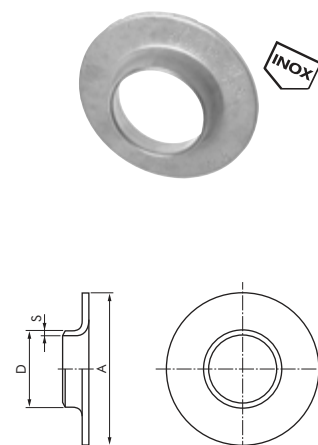

Loose flanges DIN 2642 for welding flared disks

PN 10

Versions: AISI 316Ti and zinc-plated steel: DIN 2642, stainless steel: Metal sheet pressed (similar to DIN 2642)

Optional: EN 1092-1 (type 2) -EN

Type zinc-pl. st. solid material	Type AISI 316Ti solid material	b	d	Type AISI 304 pressed	No. of holes*	S	d	b	DN	A	D	k
FL 10 L ST	FL 10 LS ES	14	14	FL 10 L ES	4	3	14.0	12.0	10	90	19	60
FL 15 L ST	FL 15 LS ES	14	14	FL 15 L ES	4	3	13.5	9.5	15	95	24	65
FL 20 L ST	FL 20 LS ES	14	14	FL 20 L ES	4	3	13.5	12.5	20	105	30	75
FL 25 L ST	FL 25 LS ES	16	14	FL 25 L ES	4	3	13.5	15.0	25	115	37	85
FL 32 L ST	FL 32 LS ES	16	18	FL 32 L ES	4	3	17.5	16.0	32	140	46	100
FL 40 L ST	FL 40 LS ES	16	18	FL 40 L ES	4	4	17.5	17.0	40	150	54	110
FL 50 L ST	FL 50 LS ES	16	18	FL 50 L ES	4	4	17.5	19.5	50	165	65	125
FL 65 L ST	FL 65 LS ES	16	18	FL 65 L ES	4	4	17.5	21.0	65	185	81	145
FL 80 L ST	FL 80 LS ES	18	18	FL 80 L ES	8	5	17.5	23.0	80	200	94	160
FL 100 L ST	FL 100 LS ES	18	18	FL 100 L ES	8	6	17.5	25.0	100	220	119	180
FL 125 L ST	FL 125 LS ES	18	18	FL 125 L ES	8	6	17.5	23.0	125	250	145	210
FL 150 L ST	FL 150 LS ES	18	22	FL 150 L ES	8	7	21.5	25.0	150	285	173	240
FL 200 L ST	FL 200 LS ES	20	22	FL 200 L ES**	8	8	21.5	28.0	200	340	225	295
FL 250 L ST	FL 250 LS ES	22	22	FL 250 L ES	12	8	21.5	34.0	250	395	279	350
FL 300 L ST	FL 300 LS ES	26	22	FL 300 L ES	12	8	21.5	38.0	300	445	329	400

* number of holes for PN 16, ** 8-hole, 12-fold on request

Order example: FL 10 L ST **

Standard type

Designation for the options:
EN 1092-1-EN

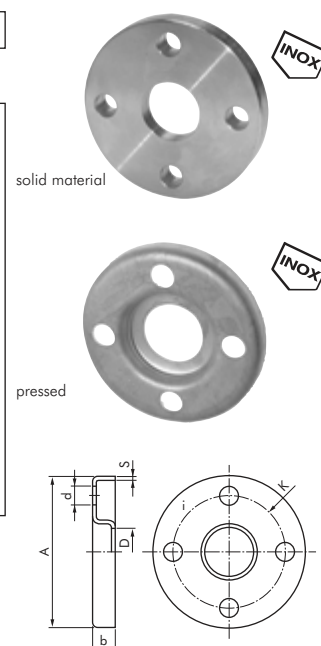

All data are considered to be unbinding reference values. We accept no liability for data selection that is not confirmed in writing. Pressure data refer, if not otherwise indicated, to liquids of Group II at +20°C.