

Especially good value!

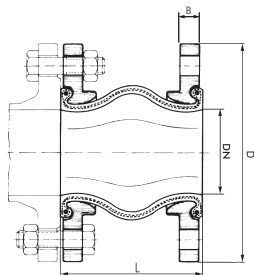

Elastomer compensators (compact)

PN 10

Version: Shallow undulating, form pressed bellows, good elastic with pressure carrier of synthetic fibre and wire enforced rubber flange collar (self-sealing), both sides rotatable steel flange

Materials: Bellows: EPDM (hot water, acid and alkalis resistant), flange: RSt 37.2 galvanised zinc-plated

Temperature range: -10 to max. +105°C (dependent on operating pressure)

Operating pressure: 10 bar (to +90°C), 8 bar (to +105°C) burst pressure 45 bar (for intermittent load the maximum operation pressure is 30 % lower.)

Connection: DIN Flanges PN 16

Type	Number of holes	DN	L	W	D
KOMFLK 40	4	40	130	16	150
KOMFLK 50	4	50	130	16	165
KOMFLK 65	4	65	130	16	185
KOMFLK 80	8	80	130	18	200
KOMFLK 100	8	100	130	18	220
KOMFLK 125	8	125	130	20	250
KOMFLK 150	8	150	130	22	285
KOMFLK 200	12	200	130	24	340

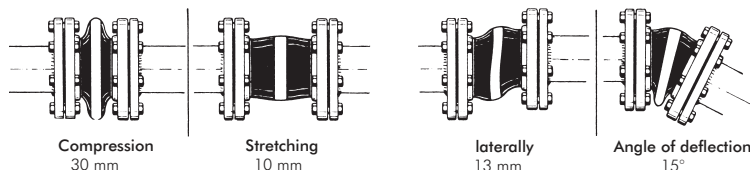

Elastomer compensators

PN 10/16

Version: Shallow undulating, form pressed bellows, good elastic with pressure carrier of synthetic fibre and wire enforced rubber flange collar (self-sealing), both sides rotatable steel flange

Materials: Bellows: EPDM (hot water, acid and alkalis resistant), flange: RSt 37.2 galvanised zinc-plated

Temperature range*: To max. +90°C (dependent on operating pressure)

Operating pressure*: 16 bar (to +50°C), 10 bar (to +80°C), 6 bar (to +90°C), burst pressure: 48 bar (For intermittent load the max. operating pressure is 30% lower.)

Connection: DIN Flanges PN 16 (DN 200 - DN 300: DIN Flanges PN 10)

Optional: Bellows from NBR (oil resistant) -B, bellows from butyl (for use with drinking water according to KTW recommendation) -LE

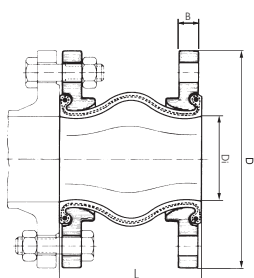

Type	DN	Axial compression	Axial stretching	± angular	PN	L	W	D	Di
KOMFL 20	20	20	10	25°	16 bar	100	16	115	22 ± 2
KOMFL 25	25	20	10	25°	16 bar	100	16	115	22 ± 2
KOMFL 32	32	35	10	25°	16 bar	125	16	140	39 ± 3
KOMFL 40	40	35	10	25°	16 bar	125	16	150	45 ± 3
KOMFL 50	50	35	10	21°	16 bar	125	16	165	56 ± 3
KOMFL 65	65	35	10	17°	16 bar	125	18	185	72 ± 3
KOMFL 80	80	40	10	14°	16 bar	150	20	200	84 ± 3
KOMFL 100	100	40	10	11°	16 bar	150	20	220	109 ± 3
KOMFL 125	125	40	10	9°	16 bar	150	22	250	133 ± 4
KOMFL 150	150	40	10	7°	16 bar	150	22	285	161 ± 4
KOMFL 175	175	40	10	6°	16 bar	150	22	315	185 ± 4
KOMFL 200	200	45	15	8°	10 bar	175	25	340	209 ± 5
KOMFL 250	250	45	15	6°	10 bar	175	25	395	262 ± 5
KOMFL 300	300	45	15	5°	10 bar	200	25	445	312 ± 5

* when installing compensators the instructions contained in the assembly instructions must be observed!

Order example: KOMFL 50 **

Standard type

Designation for the options:

Bellows from NBR (oil resistant) -B

Bellows from butyl (for drinking water) -LE

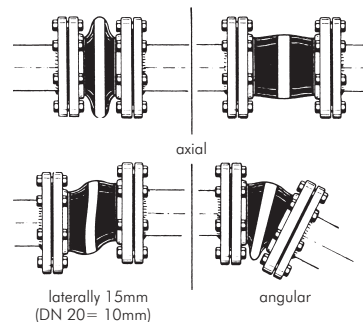

Work gloves
on page 589



Eye protection
from page 591



Cables
can be found
on page 643



Cleaner and
service products
from page 564

All data are considered to be unbinding reference values. We accept no liability for data selection that is not confirmed in writing. Pressure data refer, if not otherwise indicated, to liquids of Group II at +20°C.