

PVC threaded fittings

Threaded connections, female threads PVC-U (only for plastic threads)

PN 16

Materials: O-ring: EPDM/FKM



Warning: Not suitable for compressed air or other gases under pressure!

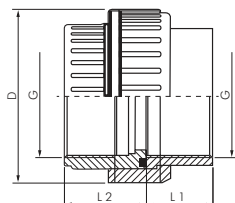

| Type EPDM | Type FKM | Thread female G | External Ø D | Install. length L1 | Install. length L2 |
|--------------------|-------------------|--------------------|-----------------|-----------------------|-----------------------|
| PVCGVIG 38 EPDM | PVCGVIG 38 FKM | Rp 3/8" | 34 | 17 | 25 |
| PVCGVIG 12 EPDM | PVCGVIG 12 FKM | Rp 1/2" | 42 | 19 | 26 |
| PVCGVIG 34 EPDM | PVCGVIG 34 FKM | Rp 3/4" | 52 | 22 | 29 |
| PVCGVIG 10 EPDM | PVCGVIG 10 FKM | Rp 1" | 59 | 25 | 32 |
| PVCGVIG 114 EPDM | PVCGVIG 114 FKM | Rp 1 1/4" | 72 | 29 | 38 |
| PVCGVIG 112 EPDM | PVCGVIG 112 FKM | Rp 1 1/2" | 79 | 34 | 45 |
| PVCGVIG 20 EPDM | PVCGVIG 20 FKM | Rp 2" | 96 | 41 | 56 |
| PVCGVIG 212 EPDM * | PVCGVIG 212 FKM * | Rp 2 1/2" | 119 | 47 | 62 |
| PVCGVIG 30 EPDM * | PVCGVIG 30 FKM * | Rp 3" | 134 | 56 | 69 |
| PVCGVIG 40 EPDM * | PVCGVIG 40 FKM * | Rp 4" | 163 | 66 | 79 |

* PN 10

Threaded angles PVC-U (only for plastic threads)

PN 10

Note: • Do not use PVC-U damaging thread seals!



Warning: Not suitable for compressed air or other gases under pressure!

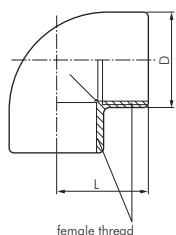

| Type | Thread | External Ø D | Installation length L |
|-----------|-----------|-----------------|--------------------------|
| W 38 PVC | Rp 3/8" | 23.5 | 23 |
| W 12 PVC | Rp 1/2" | 28.0 | 25 |
| W 34 PVC | Rp 3/4" | 34.0 | 30 |
| W 10 PVC | Rp 1" | 43.0 | 36 |
| W 114 PVC | Rp 1 1/4" | 54.0 | 41 |
| W 112 PVC | Rp 1 1/2" | 63.0 | 46 |
| W 20 PVC | Rp 2" | 78.0 | 57 |
| W 212 PVC | Rp 2 1/2" | 89.0 | 84 |
| W 30 PVC | Rp 3" | 106.0 | 99 |
| W 40 PVC | Rp 4" | 129.0 | 119 |

Threaded angles 45° PVC-U (only for plastic threads)

PN 10

Note: • Do not use PVC-U damaging thread sealing agents!



Warning: Not suitable for compressed air or other gases under pressure!

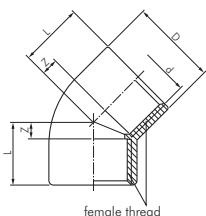

| Type | Thread | External Ø D | Installation length L | Z |
|-------------|-----------|-----------------|--------------------------|------|
| W 1245 PVC | Rp 1/2" | 28 | 15.0 | 6.0 |
| W 3445 PVC | Rp 3/4" | 34 | 16.3 | 8.7 |
| W 1045 PVC | Rp 1" | 43 | 19.1 | 10.9 |
| W 11445 PVC | Rp 1 1/4" | 54 | 21.4 | 14.6 |
| W 11245 PVC | Rp 1 1/2" | 63 | 21.4 | 21.6 |
| W 2045 PVC | Rp 2" | 78 | 25.7 | 26.3 |
| W 21245 PVC | Rp 2 1/2" | 89 | 30.2 | 30.8 |
| W 3045 PVC | Rp 3" | 106 | 33.3 | 37.7 |

Threaded T pieces PVC-U (only for plastic threads)

PN 10

Note: • Do not use PVC-U damaging thread sealing agents!



Warning: Not suitable for compressed air or other gases under pressure!

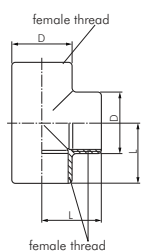

| Type | Thread | External Ø D | Installation length L |
|-----------|-----------|-----------------|--------------------------|
| T 38 PVC | Rp 3/8" | 23.5 | 23 |
| T 12 PVC | Rp 1/2" | 28.0 | 25 |
| T 34 PVC | Rp 3/4" | 34.0 | 30 |
| T 10 PVC | Rp 1" | 43.0 | 36 |
| T 114 PVC | Rp 1 1/4" | 54.0 | 41 |
| T 112 PVC | Rp 1 1/2" | 63.0 | 46 |
| T 20 PVC | Rp 2" | 78.0 | 57 |
| T 212 PVC | Rp 2 1/2" | 89.0 | 83 |
| T 30 PVC | Rp 3" | 106.0 | 99 |
| T 40 PVC | Rp 4" | 129.0 | 119 |

All data are considered to be unbinding reference values. We accept no liability for data selection that is not confirmed in writing. Pressure data refer, if not otherwise indicated, to liquids of Group II at +20°C.