

3-way flanged ball valves, reduced bore

PN 16

Materials: Housing: Steel, ball: AISI 304, seal: PTFE/FKM

Temperature range: -10°C to max. + 160°C

Pressure range: 0-16 bar, vacuum 99.9 %

Assembly flange according to ISO 5211 (not DN 15 and DN 20)

Properties: Pressure inlet only possible from the front (centre borehole).

Operating range: Water, oil, compressed air, fuel, vacuum

Optional: Pneumatic actuator** -P

Type	Type	DN	LW	L1	L2	B	d	H	G1	G2	ISO 5211*
KHFL 3/15 L	KHFL 3/15 T	15	10	40	76	65	95	64.5	4 x M12	4 x Ø14	---
KHFL 3/20 L	KHFL 3/20 T	20	15	40	82	75	105	67.0	4 x M12	4 x Ø14	---
KHFL 3/25 L	KHFL 3/25 T	25	20	46	86	85	115	79.0	4 x M12	4 x Ø14	F 04
KHFL 3/32 L	KHFL 3/32 T	32	25	58	105	100	140	84.0	4 x M16	4 x Ø18	F 04
KHFL 3/40 L	KHFL 3/40 T	40	32	71	110	110	150	102.5	4 x M16	4 x Ø18	F 05
KHFL 3/50 L	KHFL 3/50 T	50	40	82	120	125	165	109.0	4 x M16	4 x Ø18	F 05
KHFL 3/65 L	KHFL 3/65 T	65	50	106	125	145	185	128.0	4 x M16	4 x Ø18	F 07
KHFL 3/80 L	KHFL 3/80 T	80	64	122	150	160	200	136.5	8 x M16	8 x Ø18	F 07
KHFL 3/100 L	KHFL 3/100 T	100	76	152	159	180	220	155.5	8 x M16	8 x Ø18	F 10
KHFL 3/125 L	KHFL 3/125 T	125	100	196	190	210	250	178.5	8 x M16	8 x Ø18	F 10
KHFL 3/150 L	KHFL 3/150 T	150	125	242	210	240	285	252.0	8 x M20	8 x Ø22	F 12

* drive shaft delivered as 2-flat, ** please specify the exact operating case

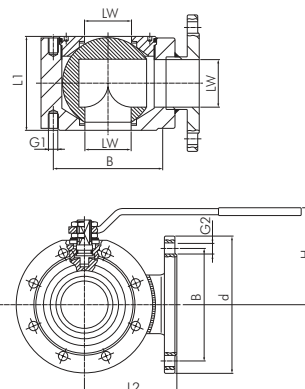

Stainless steel 3-way flanged ball valves, full bore

PN 16

Materials: Housing: AISI 316, ball: AISI 316, seal: PTFE

Temperature range: -20°C to max. + 200°C

Assembly flange conforming to ISO 5211

Properties: Pressure inlet is possible from all the three sides.

Operating range: Water, oil, compressed air, fuels, solvents, aggressive media, food, beverages

Optional: Pneumatic actuator*** -P, certificate 3.1

Type	Type	DN	L1	L2	B	d	R	t	ISO 5211
KHFL 3/25 L ES	KHFL 3/25 T* ES	25	225	112.5	85	115	172	18	F 05
KHFL 3/40 L ES	KHFL 3/40 T* ES	40	242	121.0	110	150	258	18	F 05
KHFL 3/50 L ES	KHFL 3/50 T* ES	50	250	125.0	125	165	258	18	F 07
KHFL 3/65 L ES	KHFL 3/65 T* ES	65	285	142.5	145	185	374	18	F 10
KHFL 3/80 L ES**	KHFL 3/80 T* ES**	80	297	148.5	160	200	374	20	F 10
KHFL 3/100 L ES**	KHFL 3/100 T* ES**	100	339	169.5	180	220	374	20	F 10

* please indicate the switching position. See table below (standard position T1), ** actuating lever in tube design

Order example: KHFL 3/25 L ES **

Standard type

Designation for the options:
Pneumatic actuator*** -P

*** please specify the exact operating case.

	L borehole	T borehole			
Position					
Switching position	L	T1	T2	T3	T4

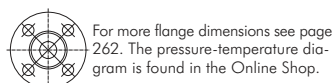
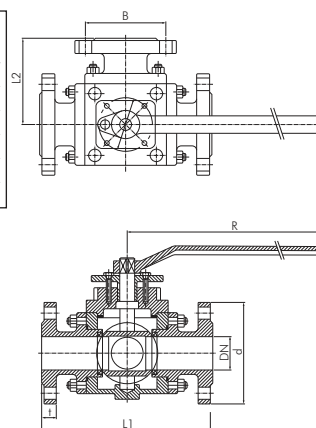

Flanges and flange seals from page 263



Flanges from page 260

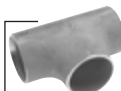

Butt weld fittings from page 254



Compensators from page 264

All data are considered to be unbinding reference values. We accept no liability for data selection that is not confirmed in writing. Pressure data refer, if not otherwise indicated, to liquids of Group II at +20°C.