

Accessories for pneumatic rotary actuators

Reducing sleeves for square drives of rotary actuators

Materials: Sintered metal, corrosion protected

Application: To reduce the female square of pneumatic or electric actuators or to enlarge the male square of fittings.

Squares in accordance to ISO 5211 - DIN 3337 - NAMUR with rounded corners and small tolerance range

Type	A	B	C	D	E
PDR 1109	11	9	12.2	14.3	10
PDR 1409	14	9	12.2	18	16
PDR 1410	14	10	13.4	18	16
PDR 1411	14	11	14.3	18	16
PDR 1711	17	11	14.3	22	17
PDR 1714	17	14	18.3	22	17
PDR 2217	22	17	22.5	28	22
PDR 2722	27	22	28.5	36	27
PDR 3627	36	27	36.0	45	36

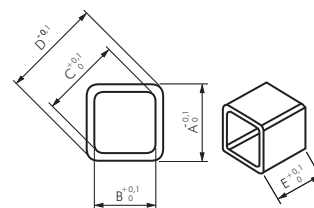

Universal signal boxes for pneumatic rotary actuators

Compact

Materials: Housing: PA, cover: Lexan 143 R, selector shaft: POM, seals: NBR, no metal parts

Temperature range: -20°C to max. +70°C

Protection class: IP 67

Connection dimensions: Fits on drilling patterns 80 x 30 and 130 x 30 (not on actuators with size 1 and 2), shaft height setting can be adjusted between 20, 30, 40 and 50 mm

- ✓ **Advantages:**
- Widely visible position indicator RED/GREEN
 - Display on drilling pattern of the ball valve is easily adjustable (T, L)

Type	Switch type	Switching capacity	Switch function
KH P END MC	Micro-switch	4V DC - 250V AC/1mA - 5A	2 toggle switches
KH P END IC	Inductive sensor	10 - 30V/100mA	2 NO contacts (PNP)
KH P END EX	Namur sensor	8V DC, I < 1mA (3mA undampened)	2 NO contacts (II2G Ex ia IIB T6)



drilling pattern
80 x 30
130 x 30

Universal signal boxes for pneumatic rotary actuators

Classic

Materials: Housing: PA6, cover: Polycarbonate, selector shaft: PA6, seals: EPDM and NBR, assembly bridge: PA6, screws: AISI 304

Temperature range: -20°C to max. +80°C, type KH P END P: -10°C to max. +60°C

Protection class: IP 67

Connection dimensions: Fits on drilling patterns 50 x 25, 80 x 30, and 130 x 30, shaft height setting can be adjusted between 20 and 30 mm, fits on all current actuators

⚠ **Warning:** For assembly on actuators of size 1 in connection with Namur valve, it may be necessary to assemble a spacer plate (DR NAMUR DIS 6) between the valve and the actuator.

Type	Switch type	Switching capacity	Switch function
KH P END M	Micro-switch	250V AC/16A	2 toggle switches
KH P END I	Inductive sensor	10-30V DC/0-100mA	2 NO contacts (PNP)
KH P END X*	Namur sensor	8V DC, I < 1mA (3mA undampened)	2 NO contacts (II2G EEx ia IIC T6)
KH P END P	3/2-way pneumatic valve	(1 to 8 bar)	2 NC contacts

* Vestamid housing and cover



drilling pattern
50 x 25
80 x 30
130 x 30

Universal signal boxes for pneumatic rotary actuators

Heavy Duty

Materials: Housing: Aluminium die-casting, cover: Polycarbonate, selector shaft: Stainless steel, seals: NBR, assembly bridge: Steel painted, screws: Stainless steel/zinc-plated steel

Temperature range: -25°C to max. +85°C

Protection class: IP 67

Connection dimensions: Fits on drilling patterns 80 x 30 and 130 x 30, shaft height setting can be adjusted between 15 and 25 mm, fits on all current actuators.

- ✓ **Advantages:**
- Robust design
 - Widely visible position indicator RED/YELLOW

Type	Switch type	Switching capacity	Switch function
KH P END MHD	Micro-switch	8 - 250V AC/DC/0.2 - 5A	2 toggle switches



drilling pattern
80 x 30
130 x 30



PU, PA, PTFE and PE hoses from page 192



Push-in fittings Ø 3 - 32 mm from page 24



NAMUR valves and NAMUR throttles on page 416



Flexible control cables on page 641

All data are considered to be unbinding reference values. We accept no liability for data selection that is not confirmed in writing. Pressure data refer, if not otherwise indicated, to liquids of Group II at +20°C.