

Tyre inflator pressure gauges/pressure indicators

Pressure gauges impact protected for hand tyre inflators Ø 63 mm, Ø 80 mm

Suitable: For uncalibrated and calibrated professional hand tyre inflator.

Materials: Housing: Steel black, measuring system and indicator: Cu-alloy, set up impact protected

- ✓ **Advantages:**
- Impact protected and overpressure safe.
 - Buffered against exterior damage with protruding rubber protection.

Type	Connection	Ø safety cap (approx.)	Class	Scale graduation	Display range
Pressure gauge Ø 63					
HRF MANO	G 1/4"	85	2.5	0.1	0/10 bar
HRFS MANO*	R 1/4"	---	2.5	0.1	0/12 bar
Pressure gauge Ø 80					
HRFG MANO	Socket Ø 15.9	100	1.0	0.1	0/12 bar
HRFG MANO 25	Socket Ø 15.9	100	1.0	0.2	0/25 bar
HRFGS MANO*	R 1/4"	---	2.5	0.1	0/12 bar

* material: plastic black



Hand tyre inflator and accessories from page 533



type HRFGS MANO



type HRF MANO



type HRFS MANO



type HRFG MANO



connection detail sockets Ø 15.9

Pressure indicators with male threads

Materials: Body: Brass nickel-plated, pin: Acetal resin, seals: NBR

Media: Oiled and unoled compressed air as well as gases

Pressure range: 2 - 12 bar

Temperature range: -15°C to max. +70°C

Type brass nickel-plated	Connection	Colour under pressure (2 - 12 bar)
Si 18 MSV	Male thread R 1/8"	● Red



depressurised



under pressure

Especially good value!



Pressure indicators with bulkhead threads

Materials: Body: Acetal resin, seals: NBR

Media: Oiled and unoled compressed air as well as gases

Pressure range: 2 - 8 bar

Temperature range: -5°C to max. +50°C

Type plastic	Connection	Colour under pressure (2 - 8 bar)
Si 4 ROT	For push-in hose with Ø 4 mm ext.	● Red
Si 4 GRUN	For push-in hose with Ø 4 mm ext.	● Green
Si 4 BLAU	For push-in hose with Ø 4 mm ext.	● Blue
Si 4 GELB	For push-in hose with Ø 4 mm ext.	● Yellow

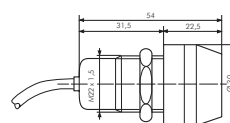

Pressure indicators made of stainless steel

Materials: Body: AISI 316, seals: NBR, inspection glass: Polyacrylic

Media: Oiled and unoled compressed air and gases, liquids, oils and water (50 µm)

Pressure range: 1 - 10 bar

Temperature range: +2°C to max. +65°C

Type AISI 316	Connection	Colour depressurised (0 - 1 bar)	Colour under pressure (1 - 10 bar)
Si 18 RG ES	G 1/8"	● Red	● Green

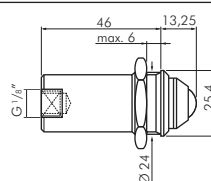

Push-in fittings Ø 3 - 32 mm from page 24



Screw connections with union nuts from page 53



PU, PA, PTFE and PE hoses from page 192



Pressure regulators of stainless steel and brass from page 355

All data are considered to be unbinding reference values. We accept no liability for data selection that is not confirmed in writing. Pressure data refer, if not otherwise indicated, to liquids of Group II at +20°C.