

Foot valves and foot switches

Especially good value!



1/2"



standard



solid

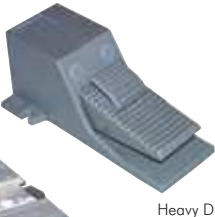

Heavy Duty



rocker valve



5/2- and 5/3-way foot valves Model series FT

Materials: Valve body: Aluminium, foot pedal: Aluminium, seals: NBR
Temperature range: -10°C to max. +60°C
Operating pressure: 1.5 - 8 bar (type 1/2": 0 - 8 bar)
Media: Oiled and unoled filtered compressed air

Type spring return	Type detend	Thread	Function	Flow	Symbol
FT410S	---	G 1/4" (venting G 1/8")	5/2-way	980 l/min.	
FT510S	---	G 3/8" (venting G 1/4")	5/2-way	1960 l/min.	
FT610S	FT620D	G 1/2"	5/2-way	5000 l/min.	
FT630S	FT630D	G 1/2"	5/3-way centre position closed	5000 l/min.	
FT640S	FT640D	G 1/2"	5/3-way centre position vented	5000 l/min.	
FT650S	FT650D	G 1/2"	5/3-way centre position breathing	5000 l/min.	

Foot valves

Temperature range: -10°C to max. +60°C
Operating pressure: 2.5 - 10 bar (model series heavy duty: 0 - 10 bar)
Media: Oiled and unoled filtered compressed air

Type spring return	Type detend	Thread	Function	Flow	Symbol
Model series standard (valve: aluminium, bodies: plastic, foot pedal: plastic)					
F 514	FMR 514	G 1/4"	5/2-way	650 l/min.	
Model series solid (valve: aluminium, bodies: plastic, foot pedal: aluminium)					
F 514 LO	FMR 514 LO	G 1/4"	5/2-way	800 l/min.	
Model series Heavy Duty (valve: aluminium, bodies: aluminium, foot pedal: aluminium)					
F 314	FMR 314	G 1/4"	3/2-way	600 l/min.	
F 414	FMR 414	G 1/4"	4/2-way	600 l/min.	
Rocker valve (valve: aluminium, bodies: Plastic foot pedal: aluminium)					
FG 5314	FGMR 5314	G 1/4"	5/3-way (centre position closed)	1200 l/min.	
FO 5314	FOMR 5314	G 1/4"	5/3-way (centre position vented)	1200 l/min.	

Foot switches

Materials: Foot pedal: Plastic, housing and protective hood: Aluminium die casting
Temperature range: -30°C to max. +80°C
Rated operating voltage: 240 V
Conventional thermal current: 10 A
Protection class: IP 65
Cable inlet: M 20 x 1.5

Type	Description
FSE	Electric floor control switch, 1 NC contact, 1 NO contact, industrial version



Push-in fittings
Ø 3 - 32 mm
from page 24

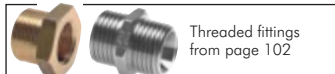

Threaded fittings
from page 102



Compressed air
and water hoses
from page 208



Silencers
from page 436



Flexible
control cables
on page 641



FESTO
Festo valves can be found
in our Online Shop



Screw connections
with union nuts
from page 53



PU, PA, PTFE and
PE hoses
from page 192

All data are considered to be unbinding reference values. We accept no liability for data selection that is not confirmed in writing. Pressure data refer, if not otherwise indicated, to liquids of Group II at +20°C.