

Check valves/hydraulic check valves

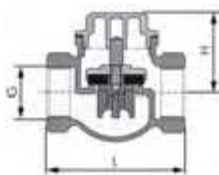

Check valves, heavy duty designs

up to 20 bar

Materials: Housing: Red bronze, screw: Brass, seal: PTFE
Temperature range: Water: -10°C to max. +100°C, saturated steam: 9 bar to max. +180°C
Installation position: Only horizontally!

Type	G	L	H	PN
RUCK 12 S	G 1/2"	60	36	20 bar
RUCK 34 S	G 3/4"	70	40	20 bar
RUCK 10 S	G 1"	84	49	20 bar
RUCK 114 S	G 1 1/4"	92	56	20 bar
RUCK 112 S	G 1 1/2"	107	61	20 bar
RUCK 20 S	G 2"	126	72	20 bar
RUCK 212 S	G 2 1/2"	135	74	16 bar
RUCK 30 S	G 3"	148	88	16 bar
RUCK 40 S	G 4"	190	110	16 bar

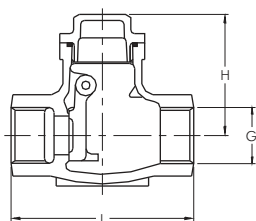

Swing check valves, metallic sealing

Eco-Line/PN 16

Materials: Housing: AISI 316, bolts: AISI 304
Temperature range: -20°C to max +200°C
Optional: Certificate 3.1

Warning: Only suitable for fluid media. Flap valve closes by gravity, therefore only possible to be installed horizontally!

Type	G	L	H
RUCK 12 S ES E	G 1/2"	65	44
RUCK 34 S ES E	G 3/4"	80	52
RUCK 10 S ES E	G 1"	89	62
RUCK 114 S ES E	G 1 1/4"	105	67
RUCK 112 S ES E	G 1 1/2"	120	79
RUCK 20 S ES E	G 2"	139	80
RUCK 212 S ES E	G 2 1/2"	181	96
RUCK 30 S ES E	G 3"	200	104

Check valves with cutting ring connections and screw-in threads

Materials: Type zinc-plated steel: Seal made of NBR, Type AISI 316Ti: Seal made of FKM
Temperature range: Type zinc-plated steel: -20°C to max. +100°C, Type AISI 316Ti: -20°C to max. +200°C
Opening pressure: Approx. 1 bar (±20%)
Optional: Open. press.: (steel: 0.5 bar -0.5, 2.0 bar -2, 2.5 bar¹⁾ -2.5, 3.0 bar²⁾ -3)

Type zinc-plated steel	Type AISI 316Ti	Type compr. ring AISI 316Ti (NC)	Tube Ø external	Screw-in thread	PN
Lightweight model series - metric screw-in threads					
RHZ 8 LM	---	---	8 L	M 12 x 1.5	250 bar
RHZ 10 LM	---	---	10 L	M 14 x 1.5	250 bar
RHZ 12 LM	---	---	12 L	M 16 x 1.5	250 bar
RHZ 15 LM	---	---	15 L	M 18 x 1.5	250 bar
RHZ 18 LM	---	---	18 L	M 22 x 1.5	160 bar
Lightweight model series - imperial screw-in threads					
RH** 6 LR	RH** 6 LR ES	RH** 6 LR NC	6 L	G 1/8"	250 bar
RH** 8 LR	RH** 8 LR ES	RH** 8 LR NC	8 L	G 1/4"	250 bar
RH** 10 LR	RH** 10 LR ES	RH** 10 LR NC	10 L	G 1/4"	250 bar
RH** 12 LR	RH** 12 LR ES	RH** 12 LR NC	12 L	G 3/8"	250 bar
RH** 15 LR	RH** 15 LR ES	RH** 15 LR NC	15 L	G 1/2"	250 bar
RH** 18 LR	RH** 18 LR ES	RH** 18 LR NC	18 L	G 1/2"	160 bar
RH** 22 LR	RH** 22 LR ES	RH** 22 LR NC	22 L	G 3/4"	160 bar
RH** 28 LR	RH** 28 LR ES	---	28 L	G 1"	100 bar
RH** 35 LR	RH** 35 LR ES	---	35 L	G 1 1/4"	100 bar
RH** 42 LR	RH** 42 LR ES	---	42 L	G 1 1/2"	100 bar
Heavy duty model series - imperial screw-in threads					
RH** 6 SR	RH** 6 SR ES	RH** 6 SR NC	6 S	G 1/4"	400 bar
RH** 8 SR	RH** 8 SR ES	RH** 8 SR NC	8 S	G 1/4"	400 bar
RH** 10 SR	RH** 10 SR ES	RH** 10 SR NC	10 S	G 3/8"	400 bar
RH** 12 SR	RH** 12 SR ES	RH** 12 SR NC	12 S	G 3/8"	400 bar
RH** 14 SR	RH** 14 SR ES	RH** 14 SR NC	14 S	G 1/2"	400 bar
RH** 16 SR	RH** 16 SR ES	RH** 16 SR NC	16 S	G 1/2"	400 bar
RH** 20 SR	RH** 20 SR ES	RH** 20 SR NC	20 S	G 3/4"	400 bar
RH** 25 SR	RH** 25 SR ES	RH** 25 SR NC	25 S	G 1"	250 bar
RH** 30 SR	RH** 30 SR ES	---	30 S	G 1 1/4"	250 bar
RH** 38 SR	RH** 38 SR ES	---	38 S	G 1 1/2"	250 bar

! In your order please enter the required opening pressure here!

Order example: RH** 6 LR **

Standard type

Designation for the options:
 Required opening pressure bar

Please enter the required flow direction here.
 Z = From tube to thread
 V = From thread to tube

