

Stainless steel cylinders ISO 15552 with magnet and adjustable end position damping

Materials: Head, foot, cylinder tube: AISI 304, piston rod: AISI 316, seal: NBR

Temperature range: -20°C to max. +80°C

Operating pressure: Max. 10 bar

Piston Ø	Piston Ø	Piston Ø	Piston Ø	Stroke
32 mm	40 mm	50 mm	63 mm	
TM 32/25 ES	TM 40/25 ES	TM 50/25 ES	TM 63/25 ES	25
TM 32/50 ES	TM 40/50 ES	TM 50/50 ES	TM 63/50 ES	50
TM 32/80 ES	TM 40/80 ES	TM 50/80 ES	TM 63/80 ES	80
TM 32/100 ES	TM 40/100 ES	TM 50/100 ES	TM 63/100 ES	100
TM 32/125 ES	TM 40/125 ES	TM 50/125 ES	TM 63/125 ES	125
TM 32/160 ES	TM 40/160 ES	TM 50/160 ES	TM 63/160 ES	160
TM 32/200 ES	TM 40/200 ES	TM 50/200 ES	TM 63/200 ES	200
TM 32/250 ES	TM 40/250 ES	TM 50/250 ES	TM 63/250 ES	250
TM 32/320 ES	TM 40/320 ES	TM 50/320 ES	TM 63/320 ES	320
TM 32/400 ES	TM 40/400 ES	TM 50/400 ES	TM 63/400 ES	400
TM 32/500 ES	TM 40/500 ES	TM 50/500 ES	TM 63/500 ES	500

Piston Ø	Piston Ø	Piston Ø	Stroke
80 mm	100 mm	125 mm	
TM 80/25 ES	TM 100/25 ES	TM 125/25 ES	25
TM 80/50 ES	TM 100/50 ES	TM 125/50 ES	50
TM 80/80 ES	TM 100/80 ES	TM 125/80 ES	80
TM 80/100 ES	TM 100/100 ES	TM 125/100 ES	100
TM 80/125 ES	TM 100/125 ES	TM 125/125 ES	125
TM 80/160 ES	TM 100/160 ES	TM 125/160 ES	160
TM 80/200 ES	TM 100/200 ES	TM 125/200 ES	200
TM 80/250 ES	TM 100/250 ES	TM 125/250 ES	250
TM 80/320 ES	TM 100/320 ES	TM 125/320 ES	320
TM 80/400 ES	TM 100/400 ES	TM 125/400 ES	400
TM 80/500 ES	TM 100/500 ES	TM 125/500 ES	500



TIP We produce your desired stroke!

! Enter your required stroke here on your order! (taking into account the buckling load)

Order example: TM 32/ ** ES

Standard type Stroke (mm) Piston Ø

Main dimensions - cylinders ISO 15552

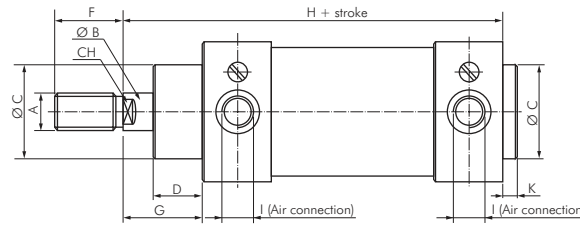
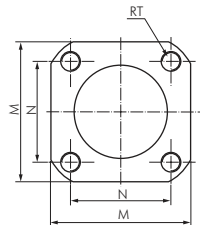

Piston Ø	32 mm	40 mm	50 mm	63 mm	80 mm	100 mm	125 mm	160 mm	200 mm	250 mm	320 mm
A	M 10 x 1.25	M 12 x 1.25	M 16 x 1.5	M 16 x 1.5	M 20 x 1.5	M 20 x 1.5	M 27 x 2	M 36 x 2	M 36 x 2	M 42 x 2	M 48 x 2
B	12	16	20	20	25	25	32	40	40	50	63
C	30	35	40	45	45	55	60	65	75	90	110
DXLE/TM	18	22	28	29	35	38	40	50	65	75	90
DXL/TM ... ES	18	22	25.5	25	35	38	46	---	---	---	---
F	22	24	32	32	40	40	54	72	72	84	96
G	26	30	37	37	46	51	65	80	95	105	120
H	120	135	143	158	174	189	225	260	275	305	340
I	G 1/8"	G 1/4"	G 1/4"	G 3/8"	G 3/8"	G 1/2"	G 1/2"	G 3/4"	G 3/4"	G 1"	G 1"
K	4	4	4	4	4	4	5 (6)	6	6	8	10
M	47 (50)	54 (55)	65	75	94 (95)	111 (110)	140	180	220	270	350
N	32.5	38	46.5	56.5	72	89	110	140	175	220	270
CH	10	13	17	17	22	22	27	36	36	46	55
RT	M 6	M 6	M 8	M 8	M 10	M 10	M 12	M 16	M 16	M 20	M 24

¹⁾ TM ... ES



Push-in fittings
Ø 3 - 32 mm
from page 24



One-way
control valves
from page 440



Valves
from page 404



PU, PA, PTFE and
PE hoses
from page 192



FESTO
Mini-carriages are found
in our Online Shop



FESTO
Festo cylinders can be
found in our Online Shop



FESTO
You will find grippers
in our Online Shop

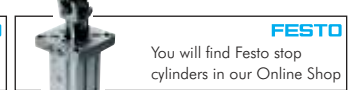

FESTO
You will find Festo stop
cylinders in our Online Shop

All data are considered to be unbinding reference values. We accept no liability for data selection that is not confirmed in writing. Pressure data refer, if not otherwise indicated, to liquids of Group II at +20°C.