

# Rodless cylinders - accessories

## Foot fastenings for rodless cylinders

Supply volume: 2 pc. mounting brackets including screws

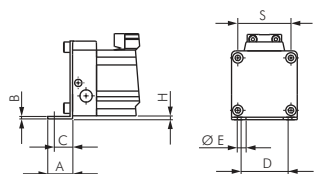

Type	A	B	C	D	E	H	For cylinder Ø
LZ 18 FB	15	2.0	10.0	20	6	2.0	18
LZ 25 FB	18	2.0	12.5	30	6	2.0	25
LZ 32 FB	20	2.5	13.5	40	7	3.0	32
LZ 40 FB	30	3.0	17.5	50	9	3.5	40
LZ 50 FB	28	3.0	20.0	60	9	3.0	50
LZ 63 FB	30	3.0	21.0	75	11	4.5	63

## Centre fastenings for rodless cylinders

Supply volume: 2 pc. centre fastening including screws

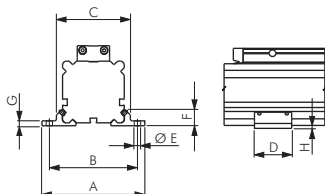

Type	A	B	C	D	E	F	G	H	For cylinder Ø
LZ 18 MB	56	46	36.5	23	3.3	8.3	2.5	2.0	18
LZ 25 MB	70	60	50.0	28	4.4	11.0	3.5	2.0	25
LZ 32 MB	85	73	61.5	33	5.3	13.8	4.0	3.0	32
LZ 40 MB	105	90	75.0	38	5.3	16.5	4.5	3.0	40
LZ 50 MB	122	106	91.0	43	8.5	19.0	5.0	3.0	50
LZ 63 MB	144	125	107.0	48	8.5	22.0	6.0	4.5	63

## Pendular bridges for rodless cylinders

**Application:** The pendular bridge is used where the rodless cylinder is used in connection with an external guide. The alignment inaccuracies (flexo-coupling) of a pendular bridge lead to twisting.

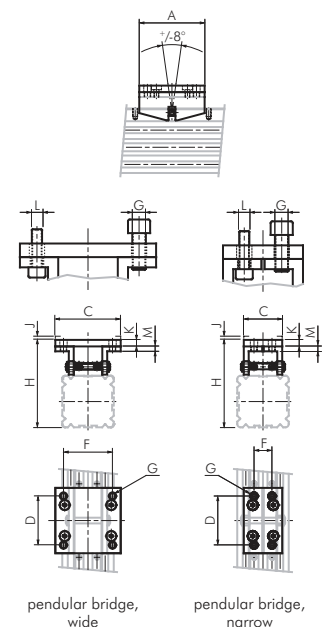

Type	A	C	D	F	G	H	J	K	M	L	For cylinder Ø
<b>Narrow pendular bridge</b>											
LZ 18 PBS	50	25.5	30	9	M 5	54.0	2.5	4	4	M 4	18
LZ 25 PBS	60	30.0	40	14	M 5	70.0	3.0	4	4	M 4	25
LZ 32 PBS	70	37.0	50	16	M 6	86.0	3.5	6	6	M 5	32
LZ 40 PBS	80	47.0	60	22	M 8	107.0	4.5	8	8	M 6	40
LZ 50 PBS	90	56.0	70	30	M 8	123.0	4.5	8	8	M 6	50
LZ 63 PBS	100	73.0	80	40	M 10	145.5	5.0	8	8	M 8	63
<b>Width pendular bridge</b>											
LZ 18 PBB	50	41.5	30	34	M 5	54.0	2.5	4	4	M 4	18
LZ 25 PBB	60	50.0	40	38	M 5	70.0	3.0	4	4	M 4	25
LZ 32 PBB	70	60.0	50	48	M 6	86.0	3.5	6	6	M 5	32
LZ 40 PBB	80	80.0	60	60	M 8	107.0	4.5	8	8	M 6	40
LZ 50 PBB	90	95.0	70	70	M 8	123.0	4.5	8	8	M 6	50
LZ 63 PBB	100	120.0	80	80	M 10	145.5	5.0	8	8	M 8	63

## Connecting plates for rodless cylinders

**Application:** The connecting plate is used to link 2 guide cylinders to a 2-axis-system. The guide cylinder must be ordered separately.

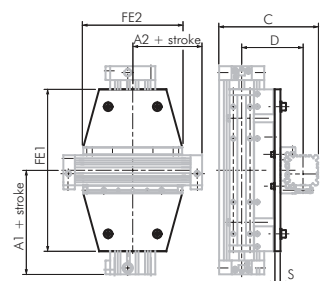

Type	A1	A2	C	D	FE1	FE2	S	Cylinder Ø1	Cylinder Ø2
LZ 18/18 KT	80	80	84.0	54.0	103	103	6	18	18
LZ 25/18 KT	100	80	100.0	64.0	131	103	8	25	18
LZ 25/25 KT	100	100	114.0	72.0	131	131	8	25	25
LZ 32/18 KT	120	80	112.0	71.0	171	103	8	32	18
LZ 32/25 KT	120	100	128.0	81.0	171	131	10	32	25
LZ 32/32 KT	120	120	140.0	88.0	171	171	10	32	32
LZ 40/25 KT	150	100	142.0	89.5	220	131	10	40	25
LZ 40/32 KT	150	120	154.0	96.5	220	171	10	40	32
LZ 40/40 KT	150	150	168.0	105.0	220	220	10	40	40
LZ 50/32 KT	180	120	171.0	106.0	280	171	10	50	32
LZ 50/40 KT	180	150	187.0	116.5	280	220	12	50	40
LZ 50/50 KT	180	180	204.0	126.0	280	280	12	50	50
LZ 63/40 KT	215	150	204.5	126.5	333	220	12	63	40
LZ 63/50 KT	215	180	221.5	136.0	333	280	12	63	50
LZ 63/63 KT	215	215	239.0	146.0	333	333	12	63	63



Push-in fittings  
Ø 3 - 32 mm  
from page 24



PU, PA, PTFE and  
PE hoses  
from page 192



Valves  
from page 404



One-way  
control valves  
from page 440

All data are considered to be unbinding reference values. We accept no liability for data selection that is not confirmed in writing. Pressure data refer, if not otherwise indicated, to liquids of Group II at +20°C.