

Industrial shock absorbers



FESTO
You will find grippers
in our Online Shop



FESTO
Festo shock absorbers can
be found in our Online Shop



FESTO
Mini-carriages are found
in our Online Shop



Exceeding W4: (max. energy absorbed per hour expressed in Nm/h) is possible when switched off temporarily or the shock absorber is cooled with the cylinder exhaust air (take note of the approved heating).

* at higher axial deviation use side load adapters (BV) (see page 505)
** construction type SC², types SC 25 EUM, SC 190 EUM supplied without impact head

Self-adjusting shock absorbers with progressive damping

Type SC/SC²

Materials: Shock absorber body and accessory: Steel nitrocarburised, piston rod: Hardened, stainless steel (type SC 45...: steel hard chrome-plated)

Temperature range: 0°C to max. +66°C (SC45...: -12°C to max. +70°C)

Stroke speed: 0.15 to 3.7 m/s (type SC²: 0.09 up to 5.7 m/s, type SC 45...: 0.15 up to 5 m/s)

Fixed limit stop: Integrated

Type	Max. energy consumption Per stroke (W3)Per hour (W4)	Effective mass (me)	Spring force	Thread	Max. axial deviation*
SC 25 EUM5**	10 Nm 16,000 Nm	1 to 5 kg	4.5 to 14 N	M 10 x 1	2°
SC 25 EUM6**	10 Nm 16,000 Nm	4 to 44 kg	4.5 to 14 N	M 10 x 1	2°
SC 25 EUM7**	10 Nm 16,000 Nm	42 to 500 kg	4.5 to 14 N	M 10 x 1	2°
SC 75 EUM5**	16 Nm 30,000 Nm	1 to 8 kg	6 to 19 N	M 12 x 1	2°
SC 75 EUM6**	16 Nm 30,000 Nm	7 to 78 kg	6 to 19 N	M 12 x 1	2°
SC 75 EUM7**	16 Nm 30,000 Nm	75 to 800 kg	6 to 19 N	M 12 x 1	2°
SC 190 EUM0	25 Nm 34,000 Nm	0.7 to 4 kg	4 to 9 N	M 14 x 1.5	5°
SC 190 EUM1	25 Nm 34,000 Nm	1.4 to 7 kg	4 to 9 N	M 14 x 1.5	5°
SC 190 EUM2	25 Nm 34,000 Nm	3.6 to 18 kg	4 to 9 N	M 14 x 1.5	5°
SC 190 EUM3	25 Nm 34,000 Nm	9 to 45 kg	4 to 9 N	M 14 x 1.5	5°
SC 190 EUM4	25 Nm 34,000 Nm	23 to 102 kg	4 to 9 N	M 14 x 1.5	5°
SC 190 EUM5**	31 Nm 50,000 Nm	2 to 16 kg	6 to 19 N	M 14 x 1.5	2°
SC 190 EUM6**	31 Nm 50,000 Nm	13 to 140 kg	6 to 19 N	M 14 x 1.5	2°
SC 190 EUM7**	31 Nm 50,000 Nm	136 to 1,550 kg	6 to 19 N	M 14 x 1.5	2°
SC 300 EUM0	33 Nm 45,000 Nm	0.7 to 4 kg	5 to 10 N	M 20 x 1.5	5°
SC 300 EUM2	33 Nm 45,000 Nm	1.4 to 8 kg	5 to 10 N	M 20 x 1.5	5°
SC 300 EUM3	33 Nm 45,000 Nm	4.5 to 27 kg	5 to 10 N	M 20 x 1.5	5°
SC 300 EUM4	33 Nm 45,000 Nm	14 to 82 kg	5 to 10 N	M 20 x 1.5	5°
SC 300 EUM5**	33 Nm 45,000 Nm	32 to 204 kg	5 to 10 N	M 20 x 1.5	5°
SC 300 EUM6**	73 Nm 45,000 Nm	11 to 45 kg	8 to 18 N	M 20 x 1.5	5°
SC 300 EUM7**	73 Nm 45,000 Nm	34 to 136 kg	8 to 18 N	M 20 x 1.5	5°
SC 300 EUM8**	73 Nm 45,000 Nm	91 to 181 kg	8 to 18 N	M 20 x 1.5	5°
SC 300 EUM9**	73 Nm 45,000 Nm	135 to 680 kg	8 to 18 N	M 20 x 1.5	5°
SC 650 EUM0	73 Nm 68,000 Nm	320 to 1,950 kg	8 to 18 N	M 20 x 1.5	5°
SC 650 EUM1	73 Nm 68,000 Nm	2.3 to 14 kg	11 to 32 N	M 25 x 1.5	5°
SC 650 EUM2	73 Nm 68,000 Nm	8 to 45 kg	11 to 32 N	M 25 x 1.5	5°
SC 650 EUM3	73 Nm 68,000 Nm	23 to 136 kg	11 to 32 N	M 25 x 1.5	5°
SC 650 EUM4	73 Nm 68,000 Nm	68 to 408 kg	11 to 32 N	M 25 x 1.5	5°
SC 650 EUM5**	73 Nm 68,000 Nm	204 to 1,180 kg	11 to 32 N	M 25 x 1.5	5°
SC 650 EUM6**	210 Nm 68,000 Nm	23 to 113 kg	11 to 33 N	M 25 x 1.5	5°
SC 650 EUM7**	210 Nm 68,000 Nm	90 to 360 kg	11 to 33 N	M 25 x 1.5	5°
SC 650 EUM8**	210 Nm 68,000 Nm	320 to 1,090 kg	11 to 33 N	M 25 x 1.5	5°
SC 650 EUM9**	210 Nm 68,000 Nm	770 to 2,630 kg	11 to 33 N	M 25 x 1.5	5°
SC 925 EUM0	210 Nm 68,000 Nm	1,800 to 6,350 kg	11 to 33 N	M 25 x 1.5	5°
SC 925 EUM1	110 Nm 90,000 Nm	4.5 to 29 kg	11 to 32 N	M 25 x 1.5	5°
SC 925 EUM2	110 Nm 90,000 Nm	14 to 90 kg	11 to 32 N	M 25 x 1.5	5°
SC 925 EUM3	110 Nm 90,000 Nm	40 to 272 kg	11 to 32 N	M 25 x 1.5	5°
SC 925 EUM4	110 Nm 90,000 Nm	113 to 726 kg	11 to 32 N	M 25 x 1.5	5°
SC 4525 EUM5	110 Nm 90,000 Nm	340 to 2,088 kg	11 to 32 N	M 25 x 1.5	5°
SC 4525 EUM6	340 Nm 107,000 Nm	3,400 to 6,800 kg	67 to 104 N	M 45 x 1.5	5°
SC 4525 EUM7	340 Nm 107,000 Nm	6,350 to 13,600 kg	67 to 104 N	M 45 x 1.5	5°
SC 4525 EUM8	340 Nm 107,000 Nm	12,700 to 22,600 kg	67 to 104 N	M 45 x 1.5	5°
SC 4525 EUM9	340 Nm 107,000 Nm	20,400 to 39,000 kg	67 to 104 N	M 45 x 1.5	5°
SC 4550 EUM6	680 Nm 112,000 Nm	6,800 to 12,200 kg	47 to 242 N	M 45 x 1.5	5°
SC 4550 EUM7	680 Nm 112,000 Nm	11,800 to 27,000 kg	47 to 242 N	M 45 x 1.5	5°
SC 4550 EUM8	680 Nm 112,000 Nm	25,800 to 44,200 kg	47 to 242 N	M 45 x 1.5	5°

Main dimensions - self-adjusting shock absorbers

Type SC/SC²

Type	A	B	C	D	E	F	Ø G	H/stroke	I	J	Ø K
SC 25 EUM	5	M 10 x 1	---	72.0	4	SW 12	3.2	8	11.0	---	---
SC 75 EUM	4	M 12 x 1	---	78.0	5	SW 14	4.0	10	14.0	---	---
SC 190 EUM0-4	7	M 14 x 1.5	SW 12	87.7	6	SW 17	4.0	16	27.0	4.6	12
SC 190 EUM5-7	5	M 14 x 1.5	---	78.0	6	SW 17	4.8	12	17.0	---	---
SC 300 EUM0-4	7	M 20 x 1.5	SW 18	87.4	8	SW 23	4.8	19	30.0	4.6	17
SC 300 EUM5-9	7	M 20 x 1.5	SW 18	79.5	8	SW 23	6.4	15	26.0	4.6	17
SC 650 EUM0-4	7	M 25 x 1.5	SW 23	106.6	10	SW 30	6.3	25	36.4	4.6	23
SC 650 EUM5-9	7	M 25 x 1.5	SW 23	106.0	10	SW 30	9.6	23	34.0	4.6	23
SC 925 EUM	7	M 25 x 1.5	SW 23	138.0	10	SW 30	6.3	40	51.0	4.6	23
SC 4525 EUM	---	M 45 x 1.5	---	164.0	9.5	---	12.6	25	25.0	19.4	42
SC 4550 EUM	---	M 45 x 1.5	---	215.0	9.5	---	12.6	50	50.0	19.4	42

* slotted nut

Impact heads for shock absorbers

Type	Usable for shock absorbers
PP 150	MC 150 EUM
PP 225	MC 225 EUM
PP 600	MC 600 EUM
PP 33	MA 33..., MC 33...
PP 45	MA 45..., MC 45..., SC 45...
PP 64	MA 64..., MC 64...

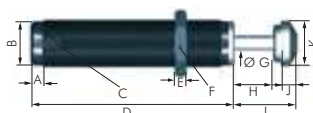

type PP 600



type PP 33

All data are considered to be unbinding reference values. We accept no liability for data selection that is not confirmed in writing. Pressure data refer, if not otherwise indicated, to liquids of Group II at +20°C.