

Blow guns

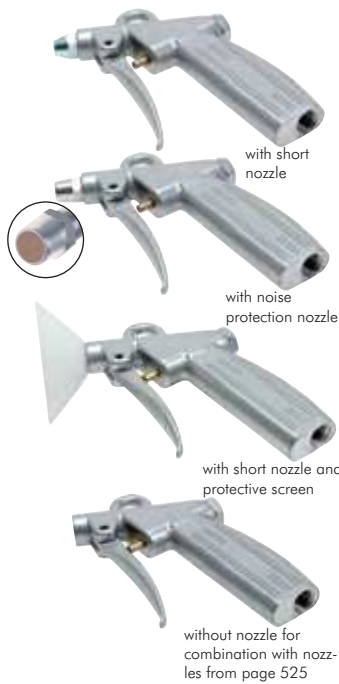

Blow guns, standard

Materials: Housing: Aluminium with plastic coating, internal parts: Brass, stainless steel, NBR, short nozzle: Zinc-plated steel, noise protection nozzle: Aluminium with sintered brass insert

✓ **Advantages:** • Warm handle feeling because of plastic seal.

Type with short nozzle Ø 1.5 (standard)	Type with noise protection nozzle	Type with short nozzle Ø 1.5 and protective screen	Type without nozzle, with female thread M 12 x 1.25**	Connection
With female thread				
BLP 14	BLP 14 LD	BLP 14 SS	BLP 14 OD	G 1/4" female thread
With hose connection				
BLP 6	BLP 6 LD	BLP 6 SS	BLP 6 OD	6 mm hose connection
BLP 9	BLP 9 LD	BLP 9 SS	BLP 9 OD	9 mm hose connection
BLP 13	BLP 13 LD	BLP 13 SS	BLP 13 OD	13 mm hose connection
With coupling plug				
BLP KS 5	---	---	---	NW 5 coupling plug
BLP KS	BLP KS LD	BLP KS SS	BLP KS OD	NW 7.2 coupling plug*
Replacement parts				
BLP 14 REP	Repair set for blow guns, standard			

* standard coupling, ** for combination with nozzles as of page 525.

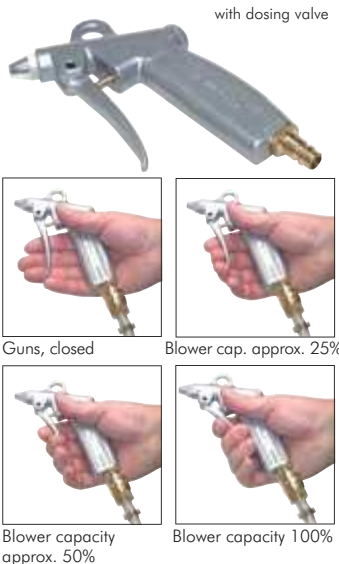

Blow guns with dosing valves

Materials: Housing: Aluminium with plastic coating, short nozzle: Zinc-plated steel, internal parts: Brass, stainless steel, NBR

✓ **Advantages:** • Warm handle feeling because of plastic seal.
• Quantity of air blown out can be metered via the actuating lever.
• Can also be used for sensitive blowing-out operations, e.g. precision engineering or the plastics industry.

Type	Nozzle bore	Connection
With female thread		
BLP 14 DOSI	1.5	G 1/4" female thread
With hose connection		
BLP 6 DOSI	1.5	6 mm hose connection
BLP 9 DOSI	1.5	9 mm hose connection
BLP 13 DOSI	1.5	13 mm hose connection
With coupling plug		
BLP KS 5 DOSI	1.5	NW 5 coupling plug
BLP KS DOSI	1.5	NW 7.2 coupling plug*
Replacement parts		
BLP 14 DOSI REP	Repair set for blow guns with dispensing valve	

* standard coupling

Blow guns sets with spiral hoses

Operating pressure: Max. 10 bar
Temperature range: -20°C to max. +60°C

✓ **Advantages:** • With rotary connections for slow rotary movements to avoid twisting the hoses.
• Axial outlets for more workspace
• Can be used immediately
• For universal use, as equipped with coupling socket and coupling plug NW 7.2

Working length 2.5 m	Working length 5 m	Working length 7.5 m	Hose Ø external x internal
SPKD 148/2.5 BLP	SPKD 148/5 BLP	SPKD 148/7.5 BLP	8 x 6

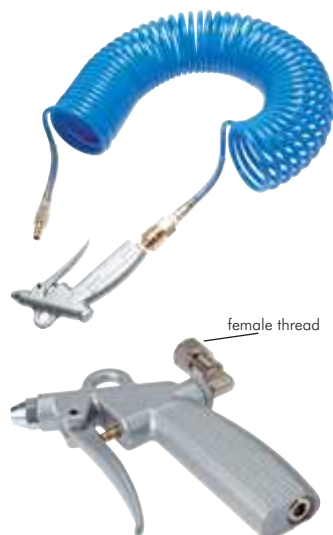

Blow guns (female threads) for connection to hose balancers

Materials: Housing: Aluminium with plastic coating, short nozzle: Zinc-plated steel, internal parts: Brass, stainless steel, NBR

Type	Nozzle bore	Connection
BLP 14 SZ	1.5	G 1/4" female thread



Hose balancers can be found on page 541.



All data are considered to be unbinding reference values. We accept no liability for data selection that is not confirmed in writing. Pressure data refer, if not otherwise indicated, to liquids of Group II at +20°C.